

#### DESCRIPTION

The MAC Series surgical suite LED flat panel is a versatile, recessed luminaire designed for healthcare and operating room environments. It is available in 1' x 2', 1' x 4', 2' x 2', and 2' x 4' sizes with white, green, or white+green LED options and a choice of full symmetric, asymmetric/symmetric, or full asymmetric light distribution. The MAC features static CCT between 2700K-5000K or green, and lumen packages from 4,000 to 25,000 lumens to fit a variety of applications.

#### SPECIFICATIONS

##### Construction:

- Cold rolled steel, stainless steel or aluminum enclosure
- Die-formed, TIG and spot welded
- Durable TGIC polyester powder coating featuring a 5-stage pre-treatment for superior adhesion and corrosion protection
- Available in Brushed, Polished or Antimicrobial White Paint that inhibits growth of bacteria on the fixture surface
- Tested to 1,000 hours salt spray with 92% reflectance
- Recessed design fits most standard T-bar grid ceilings

##### Optics/LEDs:

- Internal reflector with choice of full symmetric, asymmetric/symmetric, or full asymmetric light distribution
- Diffused acrylic DR lens for uniform LED diffusion
- Multiple lumen packages from 4,000 to 25,000 lumens
- 2700K, 3000K, 3500K, 4000K, 5000K CCT or Green
- CRI ≥ 80, optional 90 CRI (Option: 90) with White LEDs
- Efficacy up to 165 lumens per watt with White LEDs
- L70 > 100,000 hours

##### Electrical:

- Universal 120/277VAC, 50/60Hz
- 0-10V Dimming driver
- Power Factor ≥ 0.90
- 347-480VAC option (Option: HVS)

##### Installation:

- Universal mounting allows for both recessed flanged and recessed grid mounting
- Easy installation with adjustable 90° swing arm system standard

##### Options:

- Integral Battery Backup provides 14-watt emergency battery backup for continued illumination during power loss (Option: BB)
- IP65 Rated, sealed construction suitable for wet locations and high-pressure wash-down (Option: WL)
- High color-rendering LEDs with ≥90 CRI for improved color accuracy (Option: 90)

##### Testing & Compliance:

- cETL Listed
- Optional Wet Location (IP65) (Option: WL)
- Buy American Act compliant
- Build America, Buy America Act compliant
- Operating temperatures: -30°C to 50°C (-22°F to 122°F)

##### Warranty:

- Five Year Warranty (Terms and Conditions Apply)

Model: \_\_\_\_\_ Date: \_\_\_\_\_  
Accessories: \_\_\_\_\_  
Job Name: \_\_\_\_\_ Type: \_\_\_\_\_

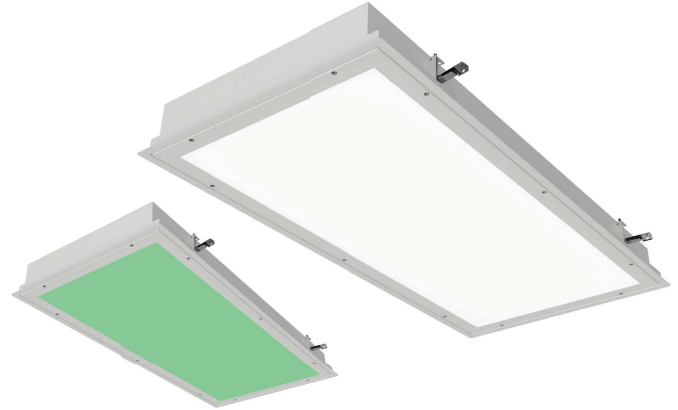

#### APPLICATIONS

- MRI Imaging Suites
- Surgical Suites



OPTIONAL

Specs at a Glance				
Size (Nominal)	1 x 2 (1' x 2')	1 x 4 (1' x 4')	2 x 2 (2' x 2')	2 x 4 (2' x 4')
Wattage (W)*	25W - 56W	25W - 81W	25W - 81W	25W - 156W
Lumens (lm)	4,000 - 9,000	4,000 - 13,000	4,000 - 13,000	4,000 - 25,000
Efficacy (LPW)	Up to 165			
CCT (K)	2700K, 3000K, 3500K, 4000K, 5000K or Green			
CRI	≥80, Optional 90			
Input Voltage	120/277VAC, 50/60Hz			
Operating Temp	-30°C to 50°C (-22°F to 122°F)			
Certifications	cETL Listed, Optional Wet Location (IP65)			
Warranty	5 Years			

\* Nominal Wattage, tested at 4000K CCT. See performance table for details.

Note: Environment and application will affect actual performance. Typical values and 25°C (77°F) used for testing. Specifications subject to change without notice.

ORDERING INFORMATION (Example: MAC-12-25-AS-PA1-VS-1-27K-A-14-A-14-I-F-AM-BB)

Model	Size	Wattage		Distribution	Lens	Voltage
MAC	12' = 1' x 2'	White LED	White and Green LED	AS = Asymmetric/Symmetric	PA1 = .125 Prismatic Acrylic	VS = 120-277VAC
	14' = 1' x 4'	25 = 25 Watt	WG31 = 22.2 Watt White, 8.75 Watt Green	FA = Full Asymmetric	PA2 = .156 Prismatic Acrylic	HVS = 347-480VAC
	22' = 2' x 2'	43 = 43.8 Watt	WG50 = 41.9 Watt White, 8.75 Watt Green	SY = Full Symmetric	PA3 = .156 Prismatic Acrylic #19	
	24 = 2' x 4'	56 = 56.2 Watt	WG68 = 48 Watt White, 20 Watt Green		PA4 = .187 Prismatic Acrylic	
		68 = 68.8 Watt	WG112 = 92 Watt White, 20 Watt Green		PP1 = Prismatic Inner with .125	
		75 = 75 Watt	Green LED		Clear Outer Polycarbonate	
		81 = 81.3 Watt	G42 = 42 Watt		SY = Symmetric Diffused DR Acrylic	
		93 = 93.8 Watt	G84 = 84 Watt			
		100 = 100 Watt	G120 = 120 Watt			
		125 = 125 Watt				
		156 = 156 Watt				

Circuits	CCT	Housing Material	Housing Gauge Size	Door Material	Door Gauge Size	Door Type	Mounting
1 = 1 Circuit	BLANK = Green LEDs	A <sup>3</sup> = Aluminum	14 = 14 Gauge	A <sup>3</sup> = Aluminum	14 = 14 Gauge	I = Inset Door	F = Flange
2 = 2 Circuit	27K = 2700K	C <sup>4</sup> = Cold Rolled Steel	18 = 18 Gauge	C <sup>5</sup> = Cold Rolled Steel	18 = 18 Gauge	O = Overlap Door	G = Grid
	3K = 3000K	S4 <sup>6</sup> = Stainless Steel 304	20 = 20 Gauge	S4 <sup>6</sup> = Stainless Steel 304	20 = 20 Gauge		
	35K = 3500K	S6 <sup>6</sup> = Stainless Steel 316		S6 <sup>6</sup> = Stainless Steel 316			
	4K = 4000K						
	5K = 5000K						

Finish	Driver	Options (Factory Installed)
AM = Antimicrobial White	BLANK = 0-10V 1% Dimming Driver	90 = 90 CRI
B <sup>6</sup> = Brushed		BB = 14 Watt Battery Backup
P <sup>6</sup> = Polished		WL = Wet Location (IP65)

Notes
<sup>1</sup> Only available in White 25, 43 and 56 Watt, White and Green 31 and 50 Watt
<sup>2</sup> Only available in White 25, 43, 56, 68, 75 and 81 Watt, White and Green 31 and 50 Watt
<sup>3</sup> Only available in 14 Gauge with Antimicrobial White Finish
<sup>4</sup> Only available in 18 and 20 Gauge
<sup>5</sup> Only available in 18 Gauge
<sup>6</sup> Only available with Stainless Steel

PERFORMANCE DATA

Model	Wattage	CCT	Lumens	LPW	CRI
MAC-XX-25	25W	2700K	3640	146	≥80
MAC-XX-25	25W	3000K	3760	150	≥80
MAC-XX-25	25W	3500K	3880	155	≥80
MAC-XX-25	25W	4000K	4000	160	≥80
MAC-XX-25	25W	5000K	4120	165	≥80
MAC-XX-43	43.8W	2700K	6370	145	≥80
MAC-XX-43	43.8W	3000K	6580	150	≥80
MAC-XX-43	43.8W	3500K	6790	155	≥80
MAC-XX-43	43.8W	4000K	7000	160	≥80
MAC-XX-43	43.8W	5000K	7210	165	≥80
MAC-XX-56	56.2W	2700K	8190	146	≥80
MAC-XX-56	56.2W	3000K	8460	151	≥80
MAC-XX-56	56.2W	3500K	8730	155	≥80
MAC-XX-56	56.2W	4000K	9000	160	≥80
MAC-XX-56	56.2W	5000K	9270	165	≥80

**PERFORMANCE DATA** (continued)

Model	Wattage	CCT	Lumens	LPW	CRI
MAC-XX-68	68.8W	2700K	10010	145	≥80
MAC-XX-68	68.8W	3000K	10340	150	≥80
MAC-XX-68	68.8W	3500K	10670	155	≥80
MAC-XX-68	68.8W	4000K	11000	160	≥80
MAC-XX-68	68.8W	5000K	11330	165	≥80
MAC-XX-75	75W	2700K	10920	146	≥80
MAC-XX-75	75W	3000K	11280	150	≥80
MAC-XX-75	75W	3500K	11640	155	≥80
MAC-XX-75	75W	4000K	12000	160	≥80
MAC-XX-75	75W	5000K	12360	165	≥80
MAC-XX-81	81.3W	2700K	11830	146	≥80
MAC-XX-81	81.3W	3000K	12220	150	≥80
MAC-XX-81	81.3W	3500K	12610	155	≥80
MAC-XX-81	81.3W	4000K	13000	160	≥80
MAC-XX-81	81.3W	5000K	13390	165	≥80
MAC-XX-93	93.8W	2700K	13650	146	≥80
MAC-XX-93	93.8W	3000K	14100	150	≥80
MAC-XX-93	93.8W	3500K	14550	155	≥80
MAC-XX-93	93.8W	4000K	15000	160	≥80
MAC-XX-93	93.8W	5000K	15450	165	≥80
MAC-XX-100	100W	2700K	14560	146	≥80
MAC-XX-100	100W	3000K	15040	150	≥80
MAC-XX-100	100W	3500K	15520	155	≥80
MAC-XX-100	100W	4000K	16000	160	≥80
MAC-XX-100	100W	5000K	16480	165	≥80
MAC-XX-125	125W	2700K	18200	146	≥80
MAC-XX-125	125W	3000K	18800	150	≥80
MAC-XX-125	125W	3500K	19400	155	≥80
MAC-XX-125	125W	4000K	20000	160	≥80
MAC-XX-125	125W	5000K	20600	165	≥80
MAC-XX-156	156.3W	2700K	22750	146	≥80
MAC-XX-156	156.3W	3000K	23500	150	≥80
MAC-XX-156	156.3W	3500K	24250	155	≥80
MAC-XX-156	156.3W	4000K	25000	160	≥80
MAC-XX-156	156.3W	5000K	25750	165	≥80

Model	White LEDs					Green LEDs		
	Wattage	CCT	Lumens	LPW	CRI	Wattage	Lumens	LPW
MAC-XX-WG31	22.5W	2700K	3276	146	≥80	8.75W	1400	160
MAC-XX-WG31	22.5W	3000K	3384	150	≥80	8.75W	1400	160
MAC-XX-WG31	22.5W	3500K	3492	155	≥80	8.75W	1400	160
MAC-XX-WG31	22.5W	4000K	3600	160	≥80	8.75W	1400	160
MAC-XX-WG31	22.5W	5000K	3708	165	≥80	8.75W	1400	160
MAC-XX-WG50	41.9W	2700K	6097	146	≥80	8.75W	1400	160
MAC-XX-WG50	41.9W	3000K	6298	150	≥80	8.75W	1400	160
MAC-XX-WG50	41.9W	3500K	6499	155	≥80	8.75W	1400	160
MAC-XX-WG50	41.9W	4000K	6700	160	≥80	8.75W	1400	160
MAC-XX-WG50	41.9W	5000K	6901	165	≥80	8.75W	1442	165

Specifications are subject to change without notice.  
Installation must be performed in accordance with  
Barron Lighting Group installation instructions.

10800467 Rev 2

**PERFORMANCE DATA** (continued)

Model	White LEDs					Green LEDs		
	Wattage	CCT	Lumens	LPW	CRI	Wattage	Lumens	LPW
MAC-XX-WG68	48W	2700K	7007	146	≥80	20W	3200	160
MAC-XX-WG68	48W	3000K	7238	151	≥80	20W	3200	160
MAC-XX-WG68	48W	3500K	7469	156	≥80	20W	3200	160
MAC-XX-WG68	48W	4000K	7700	160	≥80	20W	3200	160
MAC-XX-WG68	48W	5000K	7931	165	≥80	20W	3200	160
MAC-XX-WG102	92W	2700K	13377	145	≥80	20W	3200	160
MAC-XX-WG102	92W	3000K	13818	150	≥80	20W	3200	160
MAC-XX-WG102	92W	3500K	14259	155	≥80	20W	3200	160
MAC-XX-WG102	92W	4000K	14700	160	≥80	20W	3200	160
MAC-XX-WG102	92W	5000K	15141	165	≥80	20W	3200	160

Model	Wattage	Lumens	LPW
MAC-XX-G42	42W	6720	160
MAC-XX-G84	84W	13440	160
MAC-XX-G120	120W	19200	160

**DIMENSIONS**

**1' x 4'**

**ROUGH IN SIZE 46 11/16" X 10 5/8"**

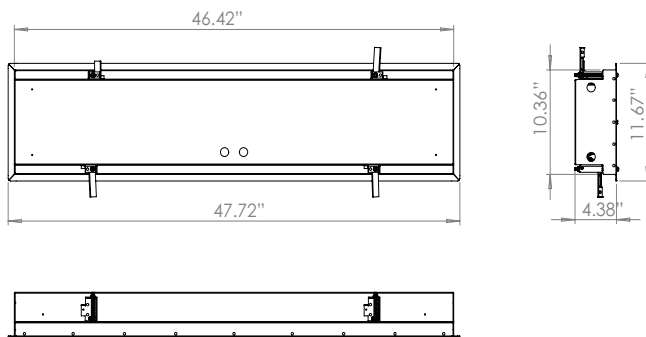

**1' x 2'**

**ROUGH IN SIZE 22 11/16" X 10 5/8"**

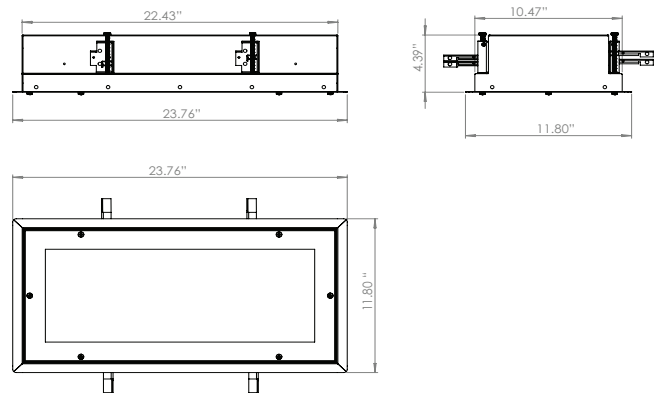

**2' x 2'**

**ROUGH IN SIZE 22 5/8" X 22 5/8"**

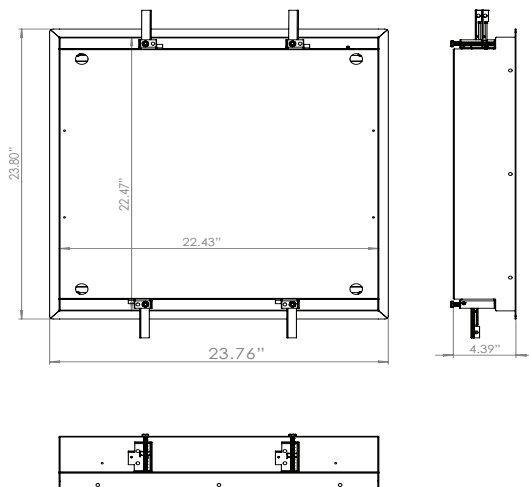

**2' x 4'**

**ROUGH IN SIZE 46 5/8" X 22 11/16"**

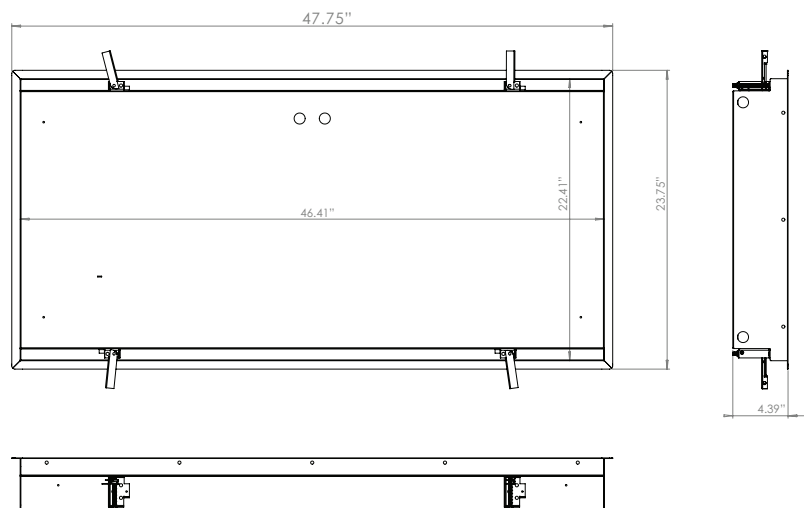

Specifications are subject to change without notice.  
Installation must be performed in accordance with  
Barron Lighting Group installation instructions.

10800467 Rev 2