

DESCRIPTION

The RXAR Series LED area luminaire offers performance and durability with a rugged, one-piece die-cast aluminum housing and high efficacy of up to 172 lumens per watt. This versatile luminaire is designed to ensure optimal heat dissipation and energy efficiency, guaranteeing longevity and reliability. It is available in Type II, III, IV, and V distributions to cater to diverse lighting needs while maintaining zero uplight to eliminate light pollution. With field switchable power (6,200 to 60,000 lumens), and CCT (3000K-4000K-5000K, depending on model), the RXAR Series offers unparalleled flexibility. Includes straight arm for mounting to 4" and 5" square or round pole standard in the packaging. Several other mounts, shields and accessories are available for maximum project flexibility.

SPECIFICATIONS

Construction:

- Sleek die-cast aluminum housing with stainless steel hardware and powder coated finish
- Integral heat sink fins maximize heat dissipation
- Hinged driver access door for ease of maintenance
- Straight arm for 4" and 5" square or round pole included standard, other mounting accessories available
- Slotted bolt pattern suitable for retrofit to most existing drill hole patterns
- Includes a 12" whip (5 conductors provided for convenience, dimming leads not connected)

Optics/LEDs:

- 40 to 400 Watts with lumen packages up to 60,000 lumens
- Designed with zero uplight to eliminate light pollution
- Efficacies up to 172 LPW maximize energy savings and utility rebates
- Type II, III, IV and V distributions optimize light distribution
- Easily field switchable between 3000K, 4000K and 5000K CCT (4000K and 5000K for 400W models)
- L70 of >100,000 hours
- L90 of 40,000 hours
- CRI ≥80

Electrical:

- Class 2 power supply, 120-277VAC, 50/60Hz
- 0-10V Dimming driver
- Power Factor ≥ 0.90
- 277-480VAC Dedicated driver option
- 10KA(@120-277V) or 20KA(@347-480V) surge protection

Testing & Compliance:

- cULus Listed for Wet Locations, tested to meet IP65 requirements
- DesignLights Consortium® (DLC) PREMIUM Qualified (consult QPL for qualified models)
- Operating temperature: -40°C to 45°C (-40°F to 113°F), -40°C to 40°C (-40°F to 104°F) for the 400W model
- 3G Vibration rated enclosure
- International Dark Sky friendly approved product. (IDA) (compliant only with a fixed downlight mount) and with factory installed RXAR-DSFA module locking CCT to 3000K

Installation:

- Hinged driver door for ease of access (coin plugs on the driver door provides ease of access to dipswitches for power and CCT selectability)
- Standard with pole mount arm suitable for 4" or 5" square or round poles. Arm features access door for easy wiring on site
- Additional contractor friendly mounts such as slipfitter, trunnion, swivel, adjustable pole mount, and wall bracket

Warranty:

- Five Year Warranty (Terms and Conditions Apply)
- 10 Year Warranty available upon request, consult factory

Options:

- 120-277VAC 3-Pin Twist Lock receptacle (option TLPC) (Twist Lock photocontrol included)
- 120-277VAC 7-Pin Twist Lock receptacle (option TLPC3) (Twist Lock photocontrol included)
- 347-480VAC 3-Pin Twist Lock Receptacle (option TLPC4) (Twist Lock photocontrol included)

Model: _____ Date: _____
Accessories: _____
Job Name: _____ Type: _____



Specs at a Glance

Model	RXAR-100	RXAR-140	RXAR-250	RXAR-300	RXAR-400
Wattage*	40W-60W-80W-100W (Switchable)	60W-90W-120W-140W (Switchable)	100W-150W-200W-250W (Switchable)	120W-180W-240W-300W (Switchable)	300W-320W-360W-400W (Switchable)
Lumens (lm)	6,400 - 16,000	9,600 - 23,000	14,500 - 38,000	18,000 - 46,000	46,000 - 60,000
Efficacy (LPW)	up to 170	up to 172	up to 161	up to 169	up to 167
Distribution	Type II, III, IV, V				
CCT (K)	3000K-4000K-5000K (Switchable)				4000K-5000K (Switchable)
CRI	>80				
Input Voltage	120-277VAC or 277-480VAC				
Operating Temp	-40°C to 45°C				-40°C to 40°C
Certifications	UL Listed for Wet Locations, IP65, DLC PREMIUM				
Warranty	5 Years				
Weight	12.0 lbs	12.4 lbs	17.4 lbs	18.0 lbs	18.5 lbs

* Nominal Wattage. Tested at 4000K CCT, 120-277VAC, Type III distribution. See performance table for more detailed lumen information.

Note: Environment and application will affect actual performance. Typical values and 25°C used for testing.

Factory Installed Accessories:

- Factory installed module to lock CCT to 3000K for Dark Sky IDA compliance (RXAR-DSFA)

Field Installed Accessories:

- 3-Pin Twist Lock universal photocontrol (120-277VAC) for dusk to dawn lighting control (TLPR)
- 3-Pin Twist Lock universal photocontrol (347-480VAC) for dusk to dawn lighting control (TLPRH)
- 7-Pin Twist Lock universal photocontrol (120-277VAC) for dusk to dawn lighting control (TLPR7)
- Bluetooth enabled dimming occupancy sensor ([LE-MS3W-BL-AUX-HB1](#)), PIR, 120/277VAC
- Dimming occupancy sensor (TL-MSP12-BL), PIR, with photocontrol, 120/277VAC
- Multiple contractor friendly mounts and accessories available, see ordering information

POLE SPECIFICATIONS

Pole Shaft:

- 4.0" (20' & 25') and 5.0" (30') Square non-tapered steel pole
- One piece construction fabricated from a weldable grade carbon steel structural tubing which has a uniform wall thickness of 11 gauge (0.1196") in the PKR20X and PKR25X models and 7 gauge (0.1793") in the PKR30X series
- Pole shaft material shall conform to ASTM A-500 Grade C with a minimum yield of 42,000 psi
- Shaft has a full length longitudinal resistance weld
- Uniformly square cross-section with flat sides, small corner radii and excellent torsional properties

Base Plate:

- Includes 2-piece ABS plastic cover is easily assembled and securely attached

Hand Hole:

- A rectangular reinforced gasketed handhole, having a nominal 3" x 5" inside opening, located 18" from the base, is standard on all poles
- A grounding provision is located inside the handhold ring

Anchor Bolt:

- Fabricated from commercial quality hot rolled carbon steel bar that meets or exceeds a minimum yield strength of 42,000 psi
- Four properly sized anchor bolts, each with two regular hex nuts and washers, are furnished and shipped with all poles unless otherwise specified
- Anchor bolts shall have the threaded end galvanized a minimum of 8" in accordance with ASTM A-153
- Anchor bolts and template shipped with pole - Note on PO if needs to ship early

Fixture Mounting:

- All poles come pre-drilled and capped on all four sides to meet desired mounting

Pole Specs at a Glance

Nominal Height	20.0'	25.0'	30.0'
Diameter	4.0"	4.0"	5.0"
Gauge	11 GA	11 GA	7 GA
Handhole Size	3.0" x 5.0"		
Anchor Bolt	.75" x 17" x 3"	.75" x 30" x 3"	1" x 36" x 4"
Bolt Circle Range	8" - 11"	8" - 11"	10.6" - 12"
Bolt Circle	9.5"	9.5"	11.3"
Max EPA (ft.2): 80 MPH	9.6	5	10.7
Max EPA (ft.2): 90 MPH	6.7	2.6	6.7
Max EPA (ft.2): 100 MPH	4.5	1	3.9
Weight	138 lbs	170 lbs	380 lbs
Warranty	1 Year		

Notes:

1. Please verify wind load ratings at project location to determine if EPA meets local code.
2. Barron Lighting Group is not responsible for pole foundation design.
3. Freight allowed on all orders exceeding (5) 20-foot poles, (4) 25-foot poles or (3) 30-foot poles.
4. Consult factory in areas where wind loading exceeds 100 mph.

Finish:

- Standard - All exterior metal surfaces are mechanically cleaned to remove all oxides and contaminants prior to coating
- Standard finish is a polyester thermosetting powder coating applied to the surface of the substrate to a minimum of 3 mils for all color finishes

Ordering Information (Example: PKR252-250-3-VS-CP-BR + PKR25-ANCKIT)

Series ¹	Wattage, Size	Distribution	Input Voltage	CCT	Finish
PKR201 = 20' Pole, 1 Head	100 = 40-100W, Small	2 = Type II	HVS ² = 277-480VAC	CP ³ = CCT & Power Switchable	BL ² = Black
PKR202 = 20' Pole, 2 Head	140 = 60-140W, Small	3 = Type III	VS = 120-277VAC		BR = Bronze
PKR203 = 20' Pole, 3 Head	250 = 100-250W, Large	4 = Type IV			SV ^{2,4} = Gray Aluminum
PKR204 = 20' Pole, 4 Head	300 = 120-300W, Large	5 = Type V			WH ² = White
PKR251 = 25' Pole, 1 Head	400 = 300-400W, Large				
PKR252 = 25' Pole, 2 Head	Options (Factory Installed)				
PKR253 = 25' Pole, 3 Head	TLPC = 120-277VAC 3-Pin Twist Lock Photocontrol and Receptacle				
PKR254 = 25' Pole, 4 Head	TLPC3 = 120-277VAC 7-Pin Twist Lock Photocontrol and Receptacle				
PKR301 = 30' Pole, 1 Head	TLPC4 = 347-480VAC 3-Pin Twist Lock Photocontrol and Receptacle				
PKR302 = 30' Pole, 2 Head					
PKR303 = 30' Pole, 3 Head	Anchor Kit⁵ (Mandatory Selection - Order as Separate Line Item)				
PKR304 = 30' Pole, 4 Head	PKR20-ANCKIT = 20' Pole Anchor Kit (4) 3/4" x 17" x 3" Anchor Bolts, (2) Nuts and Washers per bolt, (1) Template – 9.5" BC				
	PKR25-ANCKIT = 25' Pole Anchor Kit (4) 3/4" x 30" x 3" Anchor Bolts, (2) Nuts and Washers per bolt, (1) Template – 9.5" BC				
	PKR30-ANCKIT = 30' Pole Anchor Kit (4) 1" x 36" x 4" Anchor Bolts, (2) Nuts and Washers per bolt, (1) Template – 11.3" BC				

Notes	LiteLogic Accessories ⁶ (Field Installed)
¹ Fixture and pole shipped separately	LE-MS3W-BL-AUX-HB1 = Bluetooth PIR Motion Sensor with Photocontrol, Black
² 70 CRI only, longer lead times may apply, consult factory	TL-MSP12-BL = Dimming Occupancy Sensor, PIR, Black Finish
³ 400W selectable between 4000K/5000K, static 3000K option available	TL-MSSW-REMOTE = Remote for Sensor
⁴ Consult factory for lead time	TLPR = 120-277VAC 3-Pin Twist Lock Photocontrol and Receptacle
⁵ Order as separate line item, requires one (1) per pole ordered	TLPR7 = 120-277VAC 7-Pin Twist Lock Photocontrol and Receptacle
⁶ Order as separate line item	TLPRH = 347-480VAC 3-Pin Twist Lock Photocontrol and Receptacle

Sample Photometry

RXAR-140-2-VS-CP (140W, 4000K)

IES: TYPE II SHORT
MOUNTING HEIGHT: 20'
TILT: ZERO

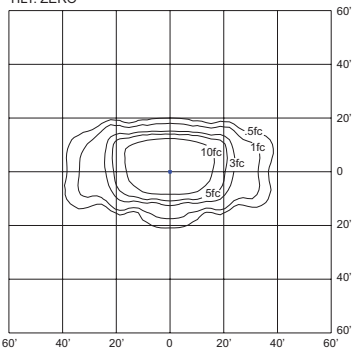

RXAR-140-3-VS-CP (140W, 4000K)

IES: TYPE III SHORT
MOUNTING HEIGHT: 20'
TILT: ZERO

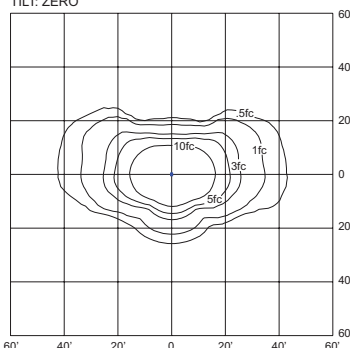

RXAR-140-4-VS-CP (140W, 4000K)

IES: TYPE IV SHORT
MOUNTING HEIGHT: 20'
TILT: ZERO

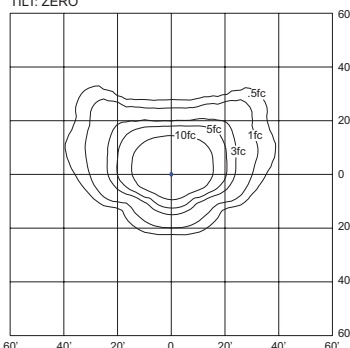

RXAR-140-5-VS-CP (140W, 4000K)

IES: TYPE VS SHORT
MOUNTING HEIGHT: 20'
TILT: ZERO

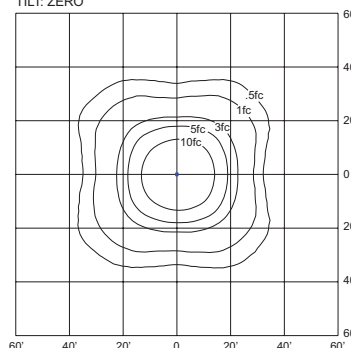



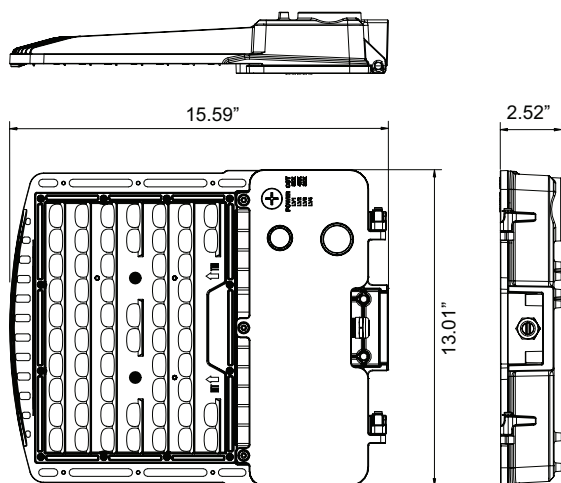

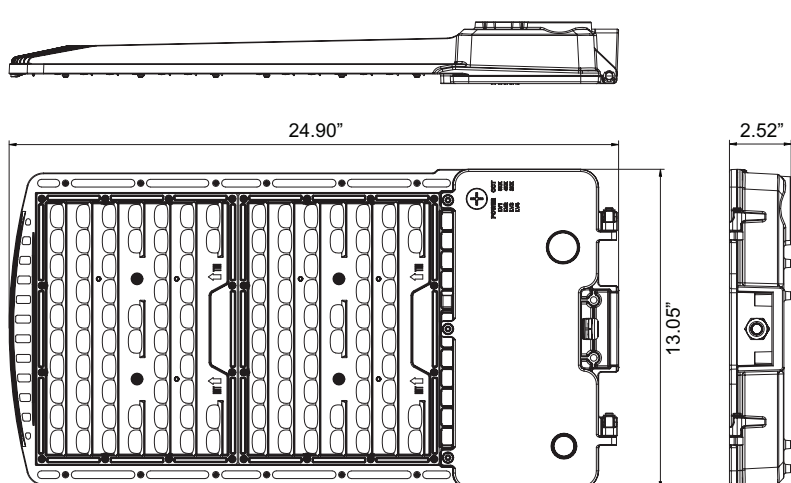

Dimensions (100/140W)



Dimensions (250/300/400W)

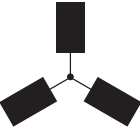

Fixture EPA Values

						
Model	1	2 @ 90°	2 @ 180°	3 @ 90°	3 @ 120°	4 @ 90°
100/140W	0.3632	0.6849	0.8861	1.0481	1.2078	1.0481
250/300/400W	0.4758	0.8091	1.059	1.2849	1.3923	1.2849

Pole EPA Values (See Page 2 for Additional Pole Information)

Pole Height (ft)	20	25	30
Max EPA (ft.2): 80 MPH	9.6	5	10.7
Max EPA (ft.2): 90 MPH	6.7	2.6	6.7
Max EPA (ft.2): 100 MPH	4.5	1	3.9

NOTE: Any pole accessories added in the field (such as banner or flag brackets) will affect published EPA values and may void factory warranties.

Base Plate Details

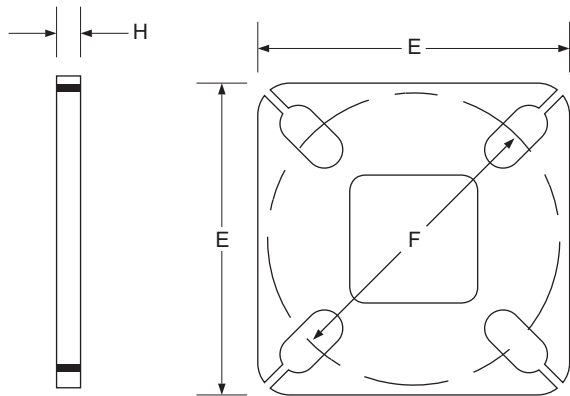

Anchor Base Size	Wall Thickness (H)	Base Plate (E)	Bolt Circle Range	Bolt Circle (F)	Bolt Projection
4"	0.75"	10.5"	8" - 11"	9.5"	3.75"
5"	1.0"	11.0"	10.6" - 12"	11.3"	4.875"

Drilling Template (Standard Mount)

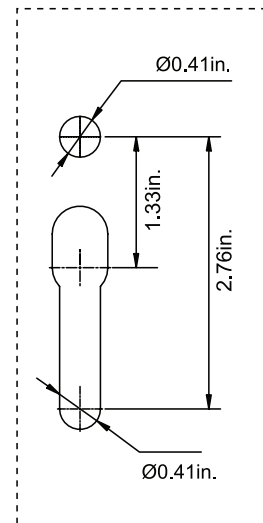

Anchor Bolt Templates

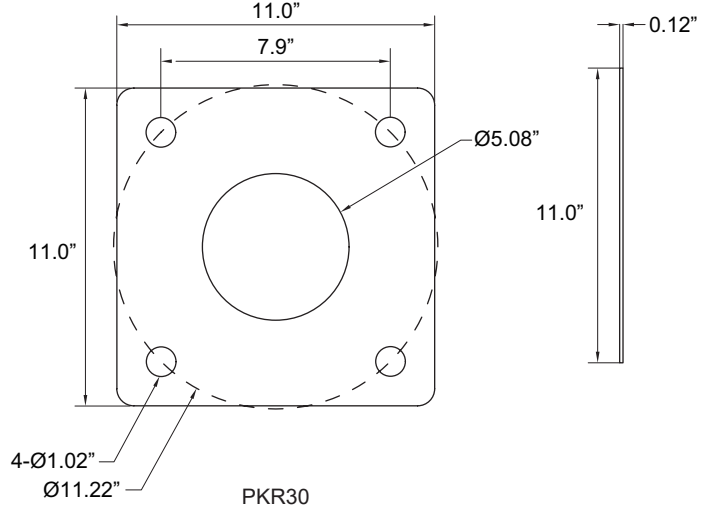
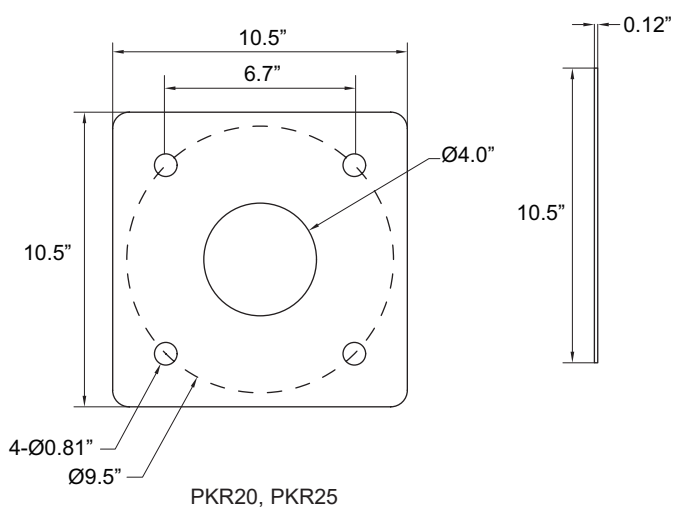

Anchor Bolt Details

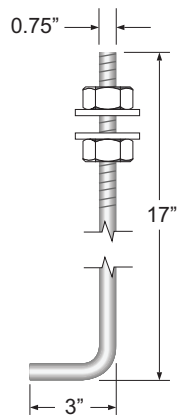

PKR20-ANCKIT

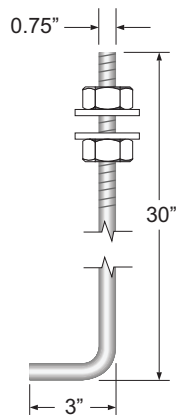

PKR25-ANCKIT

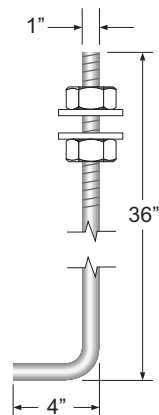

PKR30-ANCKIT

Sensor Details - Bluetooth Enabled (Accessory LE-MS3W-AUX-HB1)



LE-MS3W-BL-AUX-HB1

Coverage Side View

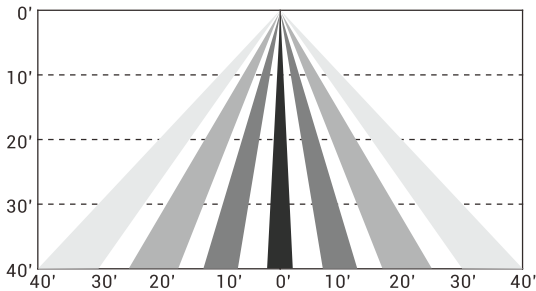

Coverage Top View (40')

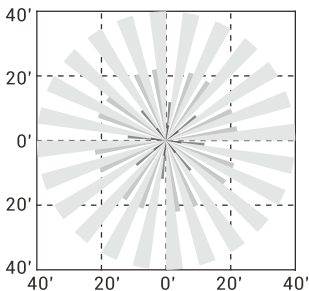

SEE APP FOR
SENSOR SETTINGS

For a complete list of **litelogic** compatible products, [click here](#).



Get it from the
App Store



Get it from
Google Play



Sensor Details (Accessories TL-MSP12-BL and TL-MSSW-REMOTE)



TL-MSP12-BL

Coverage Side View

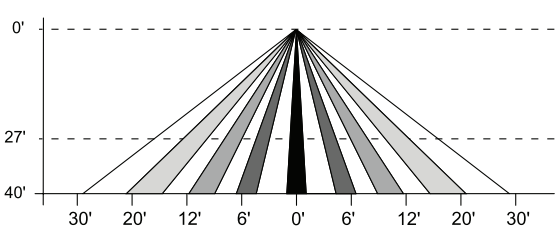

Coverage Top View (40')

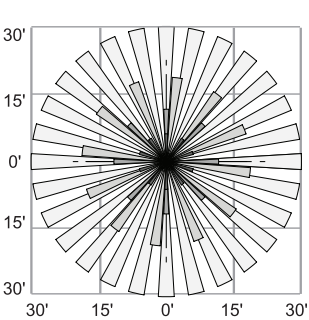

Sensor Settings (TL-MSSW-REMOTE)

DETECTION RADIUS/ANGLE	MAX 60'/360°
MOUNTING HEIGHT	MAX 40'
REMOTE RANGE	MAX 33'
FREQUENCY	5.8 GHz
HIGH MODE	70%, 80%, 90%, 100% (DEFAULT 100%)
SENSITIVITY	20%, 50%, 75%, 100% (DEFAULT 100%)
HOLD TIME	10sec, 1min, 5min, 10min, 15min, 20min, 30min, 60min (DEFAULT 5min)
DAYLIGHT HARVESTING	, (disabled), 10Lux, 30Lux, 50Lux, 100Lux, 150Lux, 200Lux, 300Lux (DEFAULT disabled)
STANDBY DIM SETTING	0, 10%, 20%, 30%, OFF (∞), (DEFAULT 30%)
STANDBY TIME SETTING (TO OFF)	ON (disabled), 1min, 30min, 60min (DEFAULT 30min)



TL-MSSW-REMOTE Accessory
(Sold Separately)

UL and DLC Nomenclature for Fixture Only (RXAR fixture is UL Listed and Appears on the DesignLights Consortium® PREMIUM Qualified Product List)

Series	Wattage, Size	Distribution	Input Voltage	CCT	Finish	Mount
RXAR	100 = 40-100W, Small	2 = Type II	HVS ¹ = 277-480VAC	CP ² = CCT & Power Switchable	BL ¹ = Black	A = Pole Mount Arm
	140 = 60-140W, Small	3 = Type III	VS = 120-277VAC		BR = Bronze	
	250 = 100-250W, Large	4 = Type IV			SV ¹ = Gray Aluminum	
	300 = 120-300W, Large	5 = Type V			WH ¹ = White	
	400 = 300-400W, Large			Options (Factory Installed)		
				TLPC = 120-277VAC 3-Pin Twist Lock Photocontrol and Receptacle		
Accessories (Factory Installed - Order As Separate Line Item)				TLPC3 = 120-277VAC 7-Pin Twist Lock Photocontrol and Receptacle		
RXAR-DSFA = Factory installed module to lock CCT to 3000K CT for Dark Sky IDA Compliance				TLPC4 = 347-480VAC 3-Pin Twist Lock Photocontrol and Receptacle		
LiteLogic Accessories³ (Field Installed - Order As Separate Line Item)				Accessories³ (Field Installed - Order As Separate Line Item)		
LE-MS3W-BL-AUX-HB1 = Bluetooth PIR Motion Sensor with Photocontrol, Black				RXAR-APM-XX ⁴ = Adjustable Pole Mount Arm (XX = BL; Black, BR; Bronze, SV; Gray Alum, WH; White)		
TL-MSP12-BL = Dimming Occupancy Sensor, PIR, Black Finish				RXAR-HSS ⁵ - House Side Shield		
TL-MSSW-REMOTE = Remote for Sensor				RXAR-L-FGS-BR = Full Glare Shield, Large, Bronze Finish (250W, 300W, 400W)		
TLPR = 120-277VAC 3-Pin Twist Lock Photocontrol and Receptacle				RXAR-L-GS-BR = Glare Shield, Large, Bronze Finish (250W, 300W, 400W)		
TLPR7 = 120-277VAC 7-Pin Twist Lock Photocontrol and Receptacle				RXAR-S-FGS-BR = Full Glare Shield, Small, Bronze Finish (100W, 140W)		
TLPRH = 347-480VAC 3-Pin Twist Lock Photocontrol and Receptacle				RXAR-S-GS-BR = Glare Shield, Small, Bronze Finish (100W, 140W)		
				RXAR-SF-XX ⁴ = Slip fitter Mount (XX = BL; Black, BR; Bronze, SV; Gray Alum, WH; White)		
Notes				RXAR-WM-XX ⁴ = Wall Mount (XX = BL; Black, BR; Bronze, SV; Gray Alum, WH; White)		
¹ 70 CRI only, longer lead times may apply, consult factory				RXAR-SW-XX ⁴ = Swivel Mount (XX = BL; Black, BR; Bronze, SV; Gray Alum, WH; White)		
² 400W Switchable between 4000K/5000K, static 3000K option available - consult factory				RXAR-TR-XX ⁴ = Trunnion Mount (XX = BL; Black, BR; Bronze, SV; Gray Alum, WH; White)		
³ Order as separate line item - Shipped in separate box for final installation in the field						
⁴ Black (BL), Gray Aluminum (SV), and White (WH) finishes may require longer lead times, consult factory						
⁵ Two (2) pieces required for 250W, 300W, and 400W units						