

The HAE LED EXIT Series is a high-performance exit sign designed to withstand demanding environments, making it ideal for correctional facilities and other public areas where safety and security are paramount.

The HAE series features a robust cold rolled or stainless steel enclosure, a polycarbonate lens, and vandal-resistant hardware, ensuring durability in even the toughest applications. It is available in side, wall, or top mounting configurations, with red or green LEDs. Additional options include self-test/self-diagnostic (G2), an IP65 rating, and a cold location battery (CL). The HAE series is the perfect solution for providing clear and reliable exit signage in entryways, stairwells, corridors, and other areas within correctional facilities, detention centers, behavioral health centers, public housing, parks, hospitals, or any space requiring a heavy-duty, vandal-resistant EXIT sign.

**FEATURES AND BENEFITS**

- Durable, high-abuse construction
- Vandal-resistant hardware
- Available in side, top and wall mount configurations
- IP65 and cold location options

**SPECIFICATIONS**

**Illumination:** Constant, uniform illumination by long-life, high intensity, red or green LEDs

**Housing:** One piece die-formed cold rolled or stainless steel

**Input:** 120/277V Dual primary, 60Hz input

**Battery:** Maintenance-free NiCad battery

**Operating Temp:** Std: 50 °F to 113 °F (10 °C to 45 °C)  
CL: 32 °F to 122 °F (0 °C to 50 °C)

**Run Time:** 90 Minute emergency run time, 24 hour recharge time

**Legend:** Fully-illuminated 6" characters with 3/4" stroke, field selectable directional chevrons included for all configurations, includes red and green diffusers

**Mounting:** Wall, Top, or Side Mount

**Finishes:** Black, White, or Brushed Finish

**Options:** Cold Location Rated, Rated IP65 (Option: CL)  
Self-Test/Self-Diagnostic (Option: G2)  
Wet Location Rated, Rated IP65 (Option:WL)

**Certifications:** Salt spray test: 1,000 hours; Reflectance: 92%  
IP65 per IEC 60598, meets or exceeds UL 924 and NFPA 101 Standards, meets or exceeds CSA and NRCAN requirements

**Warranty:** Any component that fails due to a manufacturing defect is guaranteed for five years with a separate five year prorated warranty on the battery. The warranty does not cover physical damage, abuse or instances of uncontrollable natural forces. See the full Exitronix warranty document for detailed information. (Terms and Conditions apply)

Model: \_\_\_\_\_ Date: \_\_\_\_\_  
 Accessories: \_\_\_\_\_  
 Job Name: \_\_\_\_\_ Type: \_\_\_\_\_



Wall Mount



End Mount



**ORDERING INFORMATION** Example: HAE-1-WB-B-14-R-W-TH-BF-CL

| Series | Exit Faces      | Power Source       | Housing/Door                  | Gauge Size                 | Legend Color      |
|--------|-----------------|--------------------|-------------------------------|----------------------------|-------------------|
| HAE    | 1 = Single-face | LB = AC Only       | B = Brushed Stainless Steel   | 12 <sup>1</sup> = 12 Gauge | G = Green Letters |
|        | 2 = Double-face | WB = NiCad Battery | C = Painted Cold Rolled Steel | 14 = 14 Gauge              | R = Red Letters   |
|        |                 |                    | S = Painted Stainless Steel   | 16 = 16 Gauge              |                   |
|        |                 |                    |                               | 18 = 18 Gauge              |                   |

| Mouting                     | Fasteners                   | Finish                         | Options                                     | Accessories <sup>6</sup> (Field Installed) |
|-----------------------------|-----------------------------|--------------------------------|---|--|
| S = Side Mount              | TH = Torx Head w/Center Pin | BL <sup>3</sup> = Black Finish | CL <sup>4</sup> = Cold Location (IP65)      | TS = Torx Screwdriver                      |
| T = Top Mount               |                             | BF = Brushed Finish            | G2 <sup>5</sup> = Self-Test/Self-Diagnostic |  |
| W <sup>2</sup> = Wall Mount |                             | WH <sup>3</sup> = White Finish | WL = Wet Location (IP65)                    |  |

**Notes**

- <sup>1</sup> Only available Cold Rolled Steel material
- <sup>2</sup> Wall mount is available in single-face only
- <sup>3</sup> N/A with brushed housing material
- <sup>4</sup> WL option not available with CL option
- <sup>5</sup> Only available with battery (WB)
- <sup>6</sup> Field installed, order as separate line item

**ELECTRICAL RATINGS**

| Model        | NiCad Battery | Brownout | Low Voltage Disconnect | Overload Disconnect | Short Circuit Disconnect | Solid State Transfer | Input   |    |     |     |
|--------------|---------------|----------|------------------------|---------------------|--------------------------|----------------------|---------|----|-----|-----|
|              |               |          |                        |                     |                          |                      | VAC     | Hz | mA  | W   |
| HAE-LB       | N/A           | N/A      | N/A                    | N/A                 | N/A                      | N/A                  | 120/277 | 60 | 100 | 1   |
| HAE-WB       | 1.2V 900mAh   | Yes      | No                     | No                  | N/A                      | Yes                  | 120/277 | 60 | 100 | 1   |
| HAE-WB-XX-G2 | 3.6V 400mAh   | Yes      | Yes                    | No                  | N/A                      | Yes                  | 120/277 | 60 | 50  | 2.7 |

**CONSTRUCTION**

The HAE Series features a one-piece, die-formed prime 12-18 gauge material, ensuring durability and versatility for traditional wall mounting. It is available in two surface finishes: a painted TGIC polyester applied powder coat through a five-stage pre-treatment process or a brushed stainless steel finish. This treatment, along with 0.125" polycarbonate lens, provides excellent resistance to fingerprints, surface impurities, and wear.

Field-selectable chevron knockouts are concealed and easily removable for added flexibility. Stencil letters are 6 inches high with a 3/4-inch stroke for clear visibility.

**ILLUMINATION**

Illumination of the HAE series is achieved with high output, long lasting, red or green LEDs. Includes color-matched diffuser that eliminates hot spots and striations, providing optimal light output.

**ELECTRICAL**

**Input**

Dual-voltage input 120 or 277VAC @ 60Hz.

**Sealed Nickel Cadmium Battery – NiCad (WB Only)**

Exitronix sealed nickel cadmium batteries are maintenance-free.

**Emergency**

The HAE series exit will operate for a minimum of 90 minutes during a loss of power with a 24 hour maximum recharge time for the battery.

**Test Button**

The test button is located on the side of fixture, use an allenhead wrench or a similar tool for pushing test button.

**INSTALLATION**

The hardware is tamper-resistant and constructed with rugged steel Available with a silicone gasket to achieve IP65 rating.

**CONFORMANCE TO CODES & STANDARDS**

The HAE Series meets or exceeds UL 924 and NFPA 101 Standards, meets or exceeds CSA and NRCAN requirements.

**OPTIONS**

**Cold Location (Rated IP65)**

The HAE has an internal battery heater suitable for temperature ranges from 32 °F to 122 °F (0 °C to 50 °C). This is ideal for colder climates or freezer/cold room applications.

**Wet Location (Rated IP65)**

Wet Location Rated fixture that allows water or other liquids to drip, splash or flow on or against. The construction prevents the accumulation of water on live parts.

**GUARDIAN Self-test/Self-diagnostics (G2)**

The Guardian bi-color circuit is factory preset; without any field adjustments needed. It continuously monitors the performance condition of the AC power, battery supply, and charging circuitry.

The intent of this option is to provide visual signaling to identify fault at the Exit. Fault indicators are as follow:

|       |              |                          |
|-------|--------------|--------------------------|
| ●     | Steady       | Battery Disconnected     |
| ●     | Flash        | Battery Recharge Failure |
| ● ●   | Double Blink | Battery Failure          |
| ● ● ● | Three Blink  | LED Failure              |

Self-testing/Self-diagnostics also has a manual test function, press test button as follows:

|                               |                           |
|-------------------------------|---------------------------|
| Press Test Button Once        | 30 Seconds Discharge Test |
| Press Test Button Twice       | 30 Minutes Discharge Test |
| Press Test Button Three Times | 90 Minutes Discharge Test |

**TOP MOUNT DIMENSIONS**

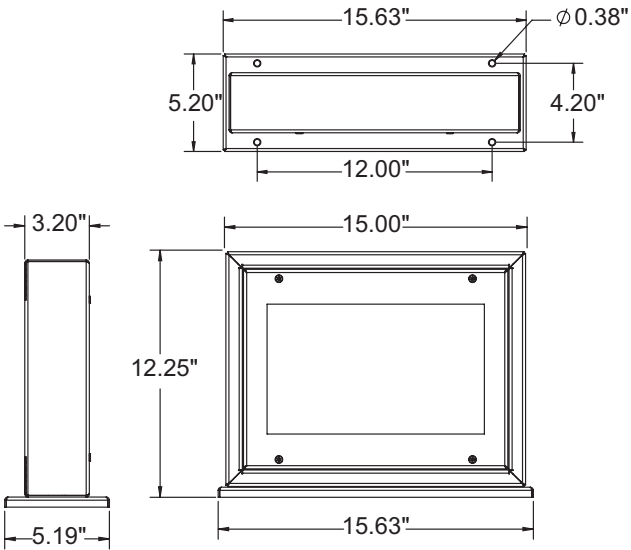

**SIDE MOUNT DIMENSIONS**

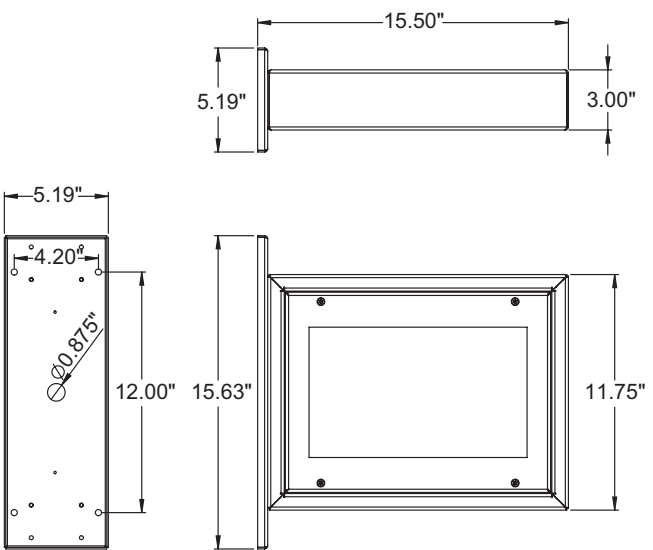

**WALL MOUNT DIMENSIONS**

