

DESCRIPTION

The FJX-VS Series is a 120-277VAC, surface mount, LED downlight offered in 3500K and 4000K CCT. The FJX's minimalistic 1/2" profile blends seamlessly in ceilings for a smooth, architectural appearance and offers even illumination with its diffused lens. The FJX-VS's rigid mounting bracket simplifies installation directly to a recessed J-box for a secure, flush fit to the ceiling. Accessories are available for installation in recessed housings. The FJX-VS Series is offered in 7" and 9" configurations with 0-10V dimming for additional energy savings. Trace-Lite's FJX-VS downlight is ideally suited for residential, retail, commercial and other interior spaces that utilize a traditional downlight or surface mount product with 120V-277V capabilities.

SPECIFICATIONS

Construction:

- Ultra-slim surface mount downlight, only 0.5" thick
- Durable white thermoplastic construction in a white finish
- Available in 7" and 9" diameters
- Aluminum heat sink to optimize thermal dissipation
- Glass light guide optimizes light uniformity
- Polystyrene diffuser
- Robust surface mount bracket for easy installation

Optics/LEDs:

- Offered in a 890 and 1340 lumen package
- 12W and 18W replaces up to 100W incandescent with up to 85% energy savings
- Low-glare diffused lens, 120° distribution
- 3500K, 4000K CCT
- L70 Rated to 50,000 hours
- CRI ≥ 80

Electrical:

- 120-277VAC, 60Hz
- 0-10VDC Dimming

Installation:

- Installs directly to 4" recessed J-box, virtually flush mount to ceiling surface (J-box min depth of 1-1/2")
- Accessory kit available for retrofit installation in a downlight (FJX-TRK-56)

Accessories (Field Installed):

- Satin nickel and matte black magnetic trims (FJX-R7-NC, FJX-R9-NC or FJX-R7-BL, FJX-R9-BL)
- Torsion clips for retrofit in recessed 5/6" housing, includes E26 medium screw-base Edison adaptor (FJX-TRK-56)

Testing & Compliance:

- cETLus Listed for Damp Locations
- Can be used for State of California Title 24 high-efficiency luminaire compliance for non-residential applications
- Operating temperatures: -20°C to 40°C (-4°F to 104°F)

Warranty:

- Five year warranty (terms and conditions apply)

Model: _____ Date: _____
Accessories: _____
Job Name: _____ Type: _____



Specs at a Glance		
Model	FJX-R7-12-VS	FJX-R9-18-VS
Diameter	7"	9"
Wattage (W)*	12W	18W
Lumens (lm)	890	1340
Efficacy (LPW)	75	75
Equivalency (W)	75W	100W
CCT (K)	3500K, 4000K	
Distribution	120°	
CRI	>80	
Input Voltage	120-277VAC, 60Hz, 0-10VDC Dimming	
Operating Temp	-20°C to 40°C (-4°F to 104°F)	
Certifications	ETL Listed, Suitable for Damp Locations	
Warranty	5 Years	
Weight	1.1 lbs	1.76 lbs

Note: Environment and application will affect actual performance. Typical values and 25°C (77°F) used for testing. Specifications subject to change without notice.

Ordering Information (Example: FJX-R7-12-VS-35K)

Model	Description
FJX-R7-12-VS-35K	Surface Mount Downlight, 7" Diameter, 12W LED, 120-277VAC, 3500K CCT, White Finish
FJX-R7-12-VS-4K	Surface Mount Downlight, 7" Diameter, 12W LED, 120-277VAC, 4000K CCT, White Finish
FJX-R9-18-VS-35K	Surface Mount Downlight, 9" Diameter, 18W LED, 120-277VAC, 3500K CCT, White Finish
FJX-R9-18-VS-4K	Surface Mount Downlight, 9" Diameter, 18W LED, 120-277VAC, 4000K CCT, White Finish

Accessories¹ (Field Installed)

FJX-R7-NC = Satin Nickel Magnetic Trim For 7" Round
FJX-R9-NC = Satin Nickel Magnetic Trim for 9" Round
FJX-R7-BL = Matte Black Magnetic Trim For 7" Round
FJX-R9-BL = Matte Black Magnetic Trim for 9" Round
FJX-TRK-56 = Torsion Clips for 5/6" Recessed Housing, E26 Socket Adapter included

Notes

¹ Order as a separate line item
 Shipped in a separate box for final installation in the field

Dimensions

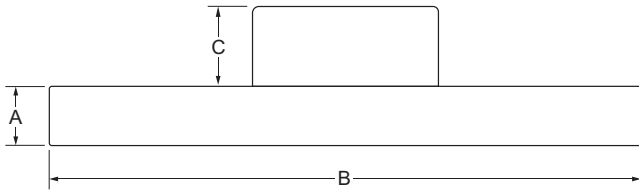

Model	A	B	C
FJX-R7-12-VS	0.5"	7.0"	1.0"
FJX-R9-18-VS	0.5"	8.9"	1.0"

Sample Photometry

FJX-R9-18-VS-35K
 IES: TYPE VS Very Short
 MOUNTING HEIGHT: 10"
 TILT: ZERO
 HORIZONTAL SPACING CRITERIA: 1.28

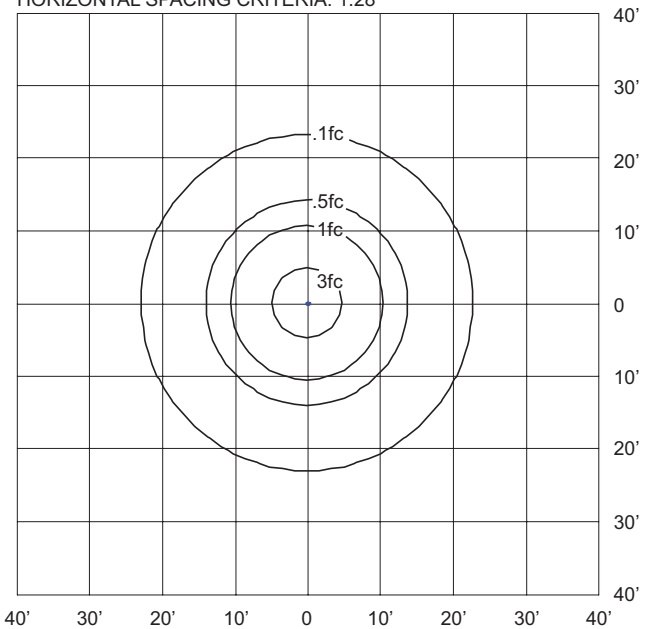

Accessories

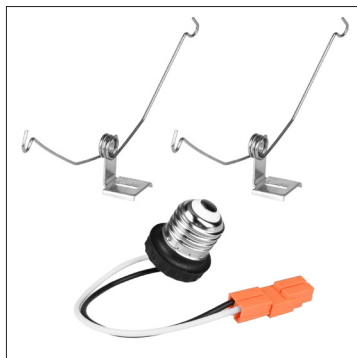

Torsion Clip Kit (FJX-TRK-56)



Satin Nickel Magnetic Trim
 (FJX-R7-NC, FJX-R9-NC)

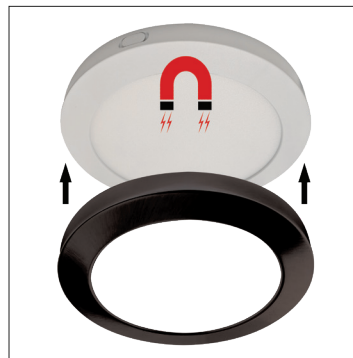

Matte Black Magnetic Trim
 (FJX-R7-BL, FJX-R9-BL)

Driver Detail

