

DESCRIPTION

The CAB Series correctional grade LED surface-mount luminaire is designed for maximum-security and behavioral-health facilities including correctional institutions, detention centers, psychiatric wards, and any high-abuse environment requiring ligature-resistant, tamper-proof lighting. Offered in 1' x 1', 1' x 2', 1' x 4', 2' x 2', and 2' x 4' sizes with static color temperatures between 2700K-5000K CCT and lumen packages from 2,000 to 30,000 lumens, the CAB delivers durable, high-performance illumination in a low-profile surface-mount design.

SPECIFICATIONS

Construction:

- Cold rolled steel or stainless steel enclosure
- Die-formed, TIG and spot welded
- Durable TGIC polyester powder coating featuring a 5-stage pre-treatment for superior adhesion and corrosion protection
- Available in brushed, white or antimicrobial white paint that inhibits growth of bacteria on the fixture surface
- Tested to 1,000 hours salt spray with 92% reflectance
- Ligature-resistant design
- Stainless steel tamper resistant T25 Torx hardware

Optics/LEDs:

- Optional Inner diffused lens for uniform LED diffusion
- Outer polycarbonate or glass lens
- Lens secured using through studs and vertically adjustable cold rolled steel internal hold-downs
- Lumen packages from 2,000 to 30,000 lumens
- 2700K, 3000K, 3500K, 4000K, 5000K CCT
- CRI ≥ 82, optional 90 CRI (Option: 90)
- Efficacy up to 165 lumens per watt
- L70 > 100,000 hours

Electrical:

- Universal 120/277VAC, 50/60Hz
- 0-10V Dimming driver
- Power factor ≥ 0.90
- 347-480VAC option (Option: HVS)

Options:

- Integral Battery Backup provides 14-watt emergency for
- continued illumination during power loss (Option: BB)
- Tamper-resistant allen head screws with center pin for enhanced security over standard Torx with center pin. Available in Stainless (Option: AH) or White (Option: AHW)
- LED Night Light offers low-level lighting without full illumination (Option: LN)
- IP65-rated sealed construction suitable for wet locations and high-pressure wash-down. (Option: WL)
- High color-rendering LEDs with ≥90 CRI for improved color accuracy (Option: 90)
- Fully integral microwave sensor for automatic occupancy control (Option: SC)

Model: _____ Date: _____
Accessories: _____
Job Name: _____ Type: _____



APPLICATIONS

- Cells
- Dayrooms (Correctional)
- Cafeterias
- Restrooms
- Showers
- Corridors
- Sally Ports
- Recreational (Correctional-Indoor)
- Behavioral Health



OPTIONAL

Installation:

- For ceiling surface mount installation

Testing & Compliance:

- cETL Listed for Damp Locations
- Optional Wet Location (Option: WL)
- IK07 Rated
- Buy American Act compliant
- Build America, Buy America Act compliant
- Operating temperatures: -20°C to 60°C (-4°F to 140°F)

Warranty:

- Five Year Warranty (Terms and Conditions Apply)

Specs at a Glance					
Model	CAB-11	CAB-12	CAB-14	CAB-22	CAB-24
Wattage (W)*	12.5W - 18.8W	12.5W - 18.8W	12.5W - 68.8W	12.5W - 81.3W	12.5W - 187.5W
Lumens (lm)	2,000 - 4,000	2,000 - 4,000	2,000 - 11,000	2,000 - 13,000	2,000 - 30,000
Efficacy (LPW)	Up to 165				
CCT (K)	2700K, 3000K, 3500K, 4000K, 5000K				
CRI	≥82, Optional 90				
Input Voltage	120/277VAC, 50/60Hz				
Operating Temp	-20°C to 60°C (-4°F to 140°F)				
Certifications	cETL Listed for Damp Locations, optional Wet Location, IK07				
Warranty	5 Years				

* Nominal Wattage, tested at 4000K CCT. See performance table for details.

Note: Environment and application will affect actual performance. Typical values and 25°C (77°F) used for testing. Specifications subject to change without notice.

ORDERING INFORMATION (Example: CAB-11-12-N-VS-27K-A-18-I-P1-WH-BB)

Model	Size	Wattage	Inner Lens	Voltage	CCT	Housing/Door Material	Gauge Size
CAB	11' = 1' x 1'	12 = 12 Watt	N = No Lens	VS = 120/277VAC	27K = 2700K	A ⁴ = Aluminum	12 = 12 Gauge
	12' = 1' x 2'	25 = 25 Watt	FA = Frosted Acrylic	HVS = 347-480VAC	3K = 3000K	C ⁵ = Cold Rolled Steel	14 = 14 Gauge
	14' = 1' x 4'	43 = 43 Watt	PA1 = .125 Prismatic Acrylic		35K = 3500K	S ⁶ = Stainless Steel	16 = 16 Gauge
	22' = 2' x 2'	68 = 68 Watt	PA2 = .156 Prismatic Acrylic		4K = 4000K		18 = 18 Gauge
	24' = 2' x 4'	75 = 75 Watt	PP1 = .125 Prismatic Polycarbonate		5K = 5000K		20 = 20 Gauge
		81 = 81 Watt	PP2 = .187 Prismatic Polycarbonate				
		93 = 93 Watt	SY = Symmetric Diffused DR Acrylic				
		100 = 100 Watt					
		125 = 125 Watt					
		156 = 156 Watt					
		187 = 187 Watt					

Door Type	Outer Lens	Finish	Driver	Options (Factory Installed)
I ⁷ = Inset Door	P1 = .125 Clear Polycarbonate	AM = Antimicrobial White	BLANK = 0-10V 1% Dimming Driver	90 = 90 CRI
O ⁷ = Overlap Door	P2 = .156 Clear Polycarbonate	B = Brushed		AH = Allenhead Screws w/ Center Pin (Stainless)
	P3 = .187 Clear Polycarbonate	WH = White		AHW = Allenhead Screws w/ Center Pin (White)
	P4 = .250 Clear Polycarbonate			BB = 14 Watt Battery Backup
	P5 = .375 Clear Polycarbonate			LNXX ⁸ = LED Night Light
	P6 = .500 Clear Polycarbonate			SC = Integral Microwave Sensor
	TG1 = .187 Clear Tempered Glass			WL = Wet Location (IP65)
	TG2 = .250 Clear Tempered Glass			
	TG3 = .375 Clear Tempered Glass			
	TG4 = .500 Clear Tempered Glass			

Notes:
¹ Only available in 12 and 25 Watt

² Only available in 12, 25, 43 and 68 Watt

³ Only available in 12, 25, 43, 68, 75, and 83 Watt

⁴ Only available in 18 Gauge with White Finish

⁵ Only available in White Finish

⁶ Only available in 14, 16, and 18 Gauge

⁷ Anti-Ligature only available with Inset Door

⁸ XX Specify CCT

PERFORMANCE DATA

Model	Wattage	CCT	Lumens	LPW	CRI
CAB-XX-12	12.5W	2700K	1820	146	≥82
CAB-XX-12	12.5W	3000K	1880	150	≥82
CAB-XX-12	12.5W	3500K	1940	155	≥82
CAB-XX-12	12.5W	4000K	2000	160	≥82
CAB-XX-12	12.5W	5000K	2060	165	≥82
CAB-XX-25	25W	2700K	3640	146	≥82
CAB-XX-25	25W	3000K	3760	150	≥82
CAB-XX-25	25W	3500K	3880	155	≥82
CAB-XX-25	25W	4000K	4000	160	≥82
CAB-XX-25	25W	5000K	4120	165	≥82
CAB-XX-43	43.8W	2700K	6370	145	≥82
CAB-XX-43	43.8W	3000K	6580	150	≥82
CAB-XX-43	43.8W	3500K	6790	155	≥82
CAB-XX-43	43.8W	4000K	7000	160	≥82
CAB-XX-43	43.8W	5000K	7210	165	≥82

Specifications are subject to change without notice.
Installation must be performed in accordance with
Barron Lighting Group installation instructions.

10800464 Rev 3

PERFORMANCE DATA (continued)

Model	Wattage	CCT	Lumens	LPW	CRI
CAB-XX-68	68.8W	2700K	10010	145	≥82
CAB-XX-68	68.8W	3000K	10340	150	≥82
CAB-XX-68	68.8W	3500K	10670	155	≥82
CAB-XX-68	68.8W	4000K	11000	160	≥82
CAB-XX-68	68.8W	5000K	11330	165	≥82
CAB-XX-75	75W	2700K	10920	146	≥82
CAB-XX-75	75W	3000K	11280	150	≥82
CAB-XX-75	75W	3500K	11640	155	≥82
CAB-XX-75	75W	4000K	12000	160	≥82
CAB-XX-75	75W	5000K	12360	165	≥82
CAB-XX-81	81.3W	2700K	11830	146	≥82
CAB-XX-81	81.3W	3000K	12220	150	≥82
CAB-XX-81	81.3W	3500K	12610	155	≥82
CAB-XX-81	81.3W	4000K	13000	160	≥82
CAB-XX-81	81.3W	5000K	13390	165	≥82
CAB-XX-93	93.8W	2700K	13650	146	≥82
CAB-XX-93	93.8W	3000K	14100	150	≥82
CAB-XX-93	93.8W	3500K	14550	155	≥82
CAB-XX-93	93.8W	4000K	15000	160	≥82
CAB-XX-93	93.8W	5000K	15450	165	≥82
CAB-XX-100	100W	2700K	14560	146	≥82
CAB-XX-100	100W	3000K	15040	150	≥82
CAB-XX-100	100W	3500K	15520	155	≥82
CAB-XX-100	100W	4000K	16000	160	≥82
CAB-XX-100	100W	5000K	16480	165	≥82
CAB-XX-125	125W	2700K	18200	146	≥82
CAB-XX-125	125W	3000K	18800	150	≥82
CAB-XX-125	125W	3500K	19400	155	≥82
CAB-XX-125	125W	4000K	20000	160	≥82
CAB-XX-125	125W	5000K	20600	165	≥82
CAB-XX-156	156.2W	2700K	22750	146	≥82
CAB-XX-156	156.2W	3000K	23500	150	≥82
CAB-XX-156	156.2W	3500K	24250	155	≥82
CAB-XX-156	156.2W	4000K	25000	160	≥82
CAB-XX-156	156.2W	5000K	25750	165	≥82
CAB-XX-187	187.5W	2700K	27300	146	≥82
CAB-XX-187	187.5W	3000K	28200	150	≥82
CAB-XX-187	187.5W	3500K	29100	155	≥82
CAB-XX-187	187.5W	4000K	30000	160	≥82
CAB-XX-187	187.5W	5000K	30900	165	≥82

DIMENSIONS

1' x 2'

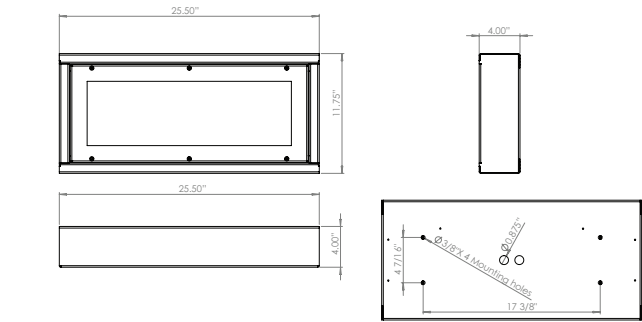

2' x 2'

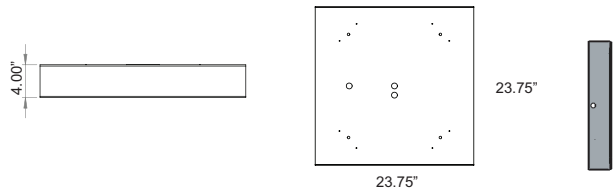

1' x 4'

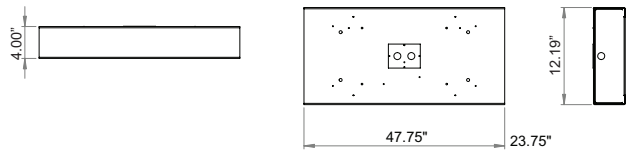

2' x 4'

