

DESCRIPTION

The AFM-M Series is a versatile area, wallpack, and floodlight solution featuring a durable die-cast aluminum housing with a textured powder coated finish. Available in multiple lumen packages up to 15,944 lumens, this compact fixture delivers long life and high performance with efficacies up to 132 lumens per watt. Offering Type I, II, III, IV, V, and Narrow Beam distributions along with multiple CCT options, the AFM-M Series provides flexible lighting for a wide range of exterior applications. Designed for adaptability, it supports a variety of mounting configurations for precise aiming and positioning, making it ideal for commercial and industrial environments requiring reliable and efficient illumination.

SPECIFICATIONS

Construction:

- Die-cast aluminum housing and front frame with nickel-plated stainless steel hardware and powder coated bronze finish
- Integral heat sink for maximized heat dissipation
- Tempered clear flat or diffused flat glass lens

Optics/LEDs:

- 68 to 121 Watts with lumen packages up to 15,944
- Type I, II, III, IV, V or Narrow Beam optics
- 3000K, 4000K, 5000K CCT
- 80 CRI
- Efficacy up to 132 lumens per watt
- L70 ≥ 320,000 hours

Electrical:

- 120-277VAC, 50/60Hz
- 0-10V Dimming driver
- Optional 347-480VAC (Option: HVS)
- Power Factor ≥ 0.90

Installation:

- Multiple mounting options available including pole mount arm, pole mount adapter, slipfitter, trunnion, and wall mount.
- Slipfitter fits standard 2 3/8" tenons; knuckle/trunnion/yoke mounts provide surface mounting capability.
- Adjustable mounts allow for field aiming and positioning.

Options:

- Fuse; Single Fuse (Option: F) or Double Fuse (Option: FD)
- PIR Motion Sensor with mounting height of 20ft - 35ft (Option: MS1)
- PIR Motion Sensor with mounting height < 18ft (Option: MS2)
- Microwave Motion Sensor with mounting height 8ft - 19ft (Option: SC1)
- Microwave Motion Sensor with mounting height < 25ft (Option: SC2)
- Twist Lock Photocontrol receptacle; 3-pin (TLPR3), 5-pin (TLPR5), 7-pin (TLPR7)
- Surge Protector; 120-277VAC Surge Protector (Option: SP)

Testing & Compliance:

- cETLus Listed for Wet Locations
- IP66 Rated LED Compartment
- Operating Temperatures: -40°C to 50°C (-40°F to 122°F)
- Buy American Act compliant

Field Installed Accessories:

- Aluminum glare/house side shield, bronze finish, includes hardware. (AFM-M-GS)
- Wire guard, stainless steel construction, includes hardware. (AFM-M-WG)
- 120-277VAC Universal Twist Lock Photocell (AFM-M-TLPC)
- 480VAC Time Delay Twist Lock Photocell (AFM-M-TLPC4)

Warranty:

- Five Year Warranty (Terms and Conditions Apply)

Model: _____ Date: _____
Accessories: _____
Job Name: _____ Type: _____



Shown with "A"
Pole Mount Arm



Shown with "SF"
Slipfitter Mount



Specs at a Glance			
Model	AFM-M-68	AFM-M-84	AFM-M-121
Wattage (W)*	68W	84W	121W
Lumens (lm)	6,158 - 7,089	9,268 - 11,007	12,986 - 15,944
Efficacy (LPW)	Up to 105	Up to 131	Up to 132
Distribution	Type III, IV, V	Type I, II, III, IV, V, Narrow Beam	Type I, II, III, IV, V, Narrow Beam
CCT (K)	3000K, 4000K, 5000K		
CRI	80		
Input Voltage	120-277VAC or 347-480VAC		
Operating Temp	-40°C to 50°C (-40°F to 122°F)		
Certifications	ETL Listed for Wet Locations, IP66 Rated LED Compartment		
Warranty	5 Years		

* Nominal Wattage, tested at 4000K CCT. See performance table for details.

Note: Environment and application will affect actual performance. Typical values and 25°C (77°F) used for testing. Specifications subject to change without notice.

ORDERING INFORMATION (Example: AFM-M-84-1-C-VS-4K-BR-A-F)

Model	Wattage	Distribution	Lens	Input Voltage	CCT	Finish
AFM-M = Medium	68 ¹ = 68 Watt	1 = Type I / NEMA 7H x 5V	C = Tempered Clear Flat Glass	VS = 120-277VAC	3K = 3000K	BR = Bronze
	84 ² = 84 Watt	2 = Type II / NEMA 7H x 6V	D ⁵ = Diffused Flat Glass	HVS ⁶ = 347-480VAC	4K = 4000K	
	121 ³ = 121 Watt	3 = Type III / NEMA 7H x 7V			5K = 5000K	
		4 = Type IV / NEMA 6H x 5V				
		5 = Type V / NEMA 7H x 7V				
	N ⁴ = Narrow Beam / NEMA 4H x 4V					

Mounting	Options	Accessories ⁹ (Field installed, order as separate line item)
BLANK = No Mount	F ⁷ = Fuse	AFM-M-GS = Glare Shield, Bronze Finish
A = Pole Mount Arm	FD ⁷ = Double Fuse	AFM-M-WG = Wire Guard, Stainless Steel
PA = Pole Mount Adapter	MS1 ⁷ = PIR Motion Sensor, Mounting Height 20ft - 35ft	AFM-M-TLPC = 120-277VAC Universal Twist Lock Photocell
SF = Slipfitter	MS2 ⁷ = PIR Motion Sensor, Mounting Height <18ft	AFM-M-TLPC4 = 480VAC Time Delay Twist Lock Photocell. For 480V use only.
T = Trunnion Mount	SC1 ⁷ = Microwave Motion Sensor, Mounting Height 8ft - 19ft	
W = Wall Mount	SC2 ⁷ = Microwave Motion Sensor, Mounting Height <25ft	
WB= Wall Mount Box	SP ⁷ = 120-277VAC Surge Protector	
	TLPR3 ⁸ = 3-Pin Twist Lock Receptacle	
	TLPR5 ⁸ = 5-Pin Twist Lock Receptacle	
	TLPR7 ⁸ = 7-Pin Twist Lock Receptacle	

Notes:

¹ Not available in Type III 3000K, Type IV 4000K and 5000K, Type V 3000K

² Not available in Type I 3000K

³ Not available in Type I and Type II 3000K

⁴ Only available in 84W and 121W, 5000K configurations

⁵ Type V only

⁶ Not available in 121W

⁷ 120-277VAC Only

⁸ Order Photocontrol as a separate line item, see Accessories

⁹ Order as a separate line item, shipped in separate box for final installation in the field

PERFORMANCE DATA

Model	Wattage	CCT	Lumens	LPW	BUG Rating	CRI
AFM-M-68-3	68W	4000K	6,823	101	B2-U0-G2	80
AFM-M-68-3	68W	5000K	7,089	105	B2-U0-G2	80
AFM-M-68-4	68W	3000K	6,158	73	B1-U0-G2	80
AFM-M-68-5	68W	4000K	6,508	96	B2-U0-G0	80
AFM-M-68-5	68W	5000K	6,762	100	B2-U0-G0	80
AFM-M-84-1	84W	4000K	10,109	120	B3-U0-G1	80
AFM-M-84-1	84W	5000K	10,503	125	B3-U0-G2	80
AFM-M-84-2	84W	3000K	9,268	110	B2-U0-G2	80
AFM-M-84-2	84W	4000K	9,644	115	B2-U0-G2	80
AFM-M-84-2	84W	5000K	10,019	119	B2-U0-G2	80
AFM-M-84-3	84W	3000K	10,181	121	B2-U0-G2	80
AFM-M-84-3	84W	4000K	10,594	126	B2-U0-G2	80
AFM-M-84-3	84W	5000K	11,007	131	B2-U0-G2	80
AFM-M-84-4	84W	3000K	9,563	114	B1-U0-G2	80
AFM-M-84-4	84W	4000K	9,950	118	B1-U0-G2	80
AFM-M-84-4	84W	5000K	10,338	123	B1-U0-G2	80
AFM-M-84-5	84W	3000K	9,712	115	B3-U0-G1	80
AFM-M-84-5	84W	4000K	10,106	120	B3-U0-G1	80
AFM-M-84-5	84W	5000K	10,499	125	B3-U0-G1	80
AFM-M-84-N	84W	5000K	10,181	121	-	80

Specifications are subject to change without notice.
Installation must be performed in accordance with
Barron Lighting Group installation instructions.

PERFORMANCE DATA (continued)

Model	Wattage	CCT	Lumens	LPW	BUG Rating	CRI
AFM-M-121-1	121W	4000K	14,644	121	B3-U0-G2	80
AFM-M-121-1	121W	5000K	15,214	126	B3-U0-G2	80
AFM-M-121-2	121W	4000K	13,970	115	B2-U0-G2	80
AFM-M-121-2	121W	5000K	14,514	120	B2-U0-G2	80
AFM-M-121-3	121W	3000K	14,748	122	B3-U0-G3	80
AFM-M-121-3	121W	4000K	15,346	127	B3-U0-G3	80
AFM-M-121-3	121W	5000K	15,944	132	B3-U0-G3	80
AFM-M-121-4	121W	3000K	12,986	107	B2-U0-G3	80
AFM-M-121-4	121W	4000K	13,513	112	B2-U0-G3	80
AFM-M-121-4	121W	5000K	14,039	116	B2-U0-G3	80
AFM-M-121-5	121W	3000K	13,161	109	B3-U0-G1	80
AFM-M-121-5	121W	4000K	13,637	113	B3-U0-G1	80
AFM-M-121-5	121W	5000K	15,209	126	B3-U0-G1	80
AFM-M-121-N	121W	5000K	14,078	116	-	80

DIMENSIONS

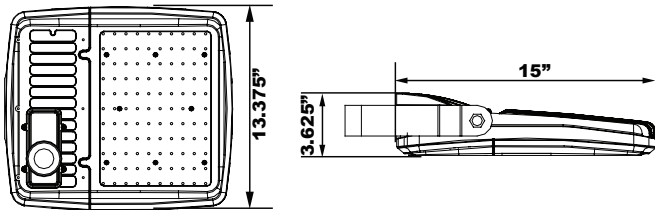

MOUNTING OPTIONS



Pole Mount Arm
(Option: A)



Pole Mount Adapter
(Option: PA)



Slipfitter
(Option: SF)



Trunnion Mount
(Option: T)



Wall Mount
(Option: W)



Yoke Mount
(Option: Y)

Specifications are subject to change without notice.
Installation must be performed in accordance with
Barron Lighting Group installation instructions.

10810494 Rev 1

ACCESSORIES (sold separately for field installation)



Glare Shield
AFM-M-GS
(Sold Separately)

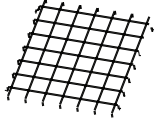

Wireguard
AFM-M-WG
(Sold Separately)